

Shades

Designed by Char Hopeman
Featuring Nancy Gere's *Shades of Grey* Collection

SIZE: 64" x 81"

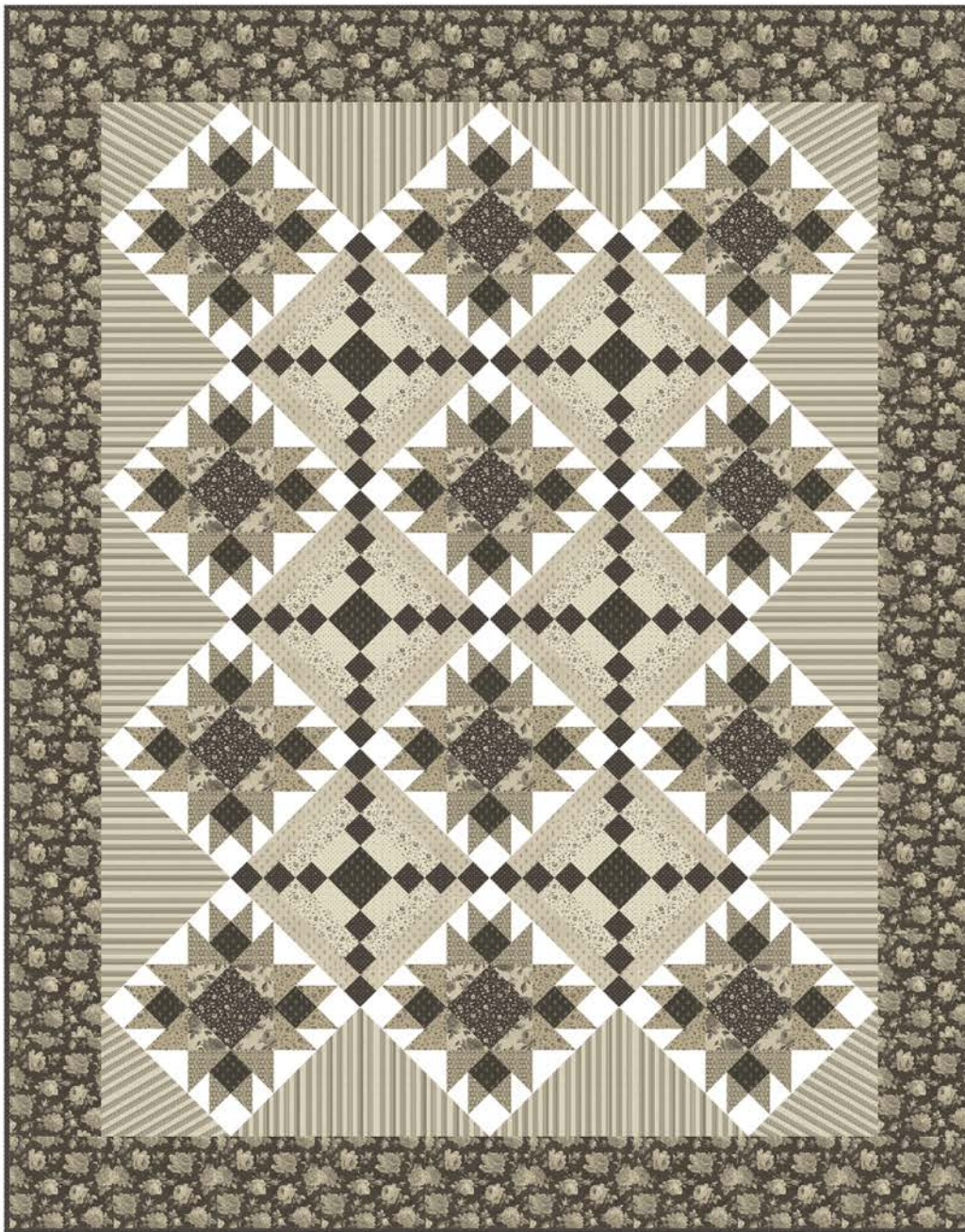

PLEASE NOTE: QUILT IMAGE SHOWN IS A DIGITAL REPRESENTATION, FABRIC LOOK MAY VARY ON YOUR PROJECT.
VISIT OUR *FREE PROJECT* SECTION ONLINE FOR ANY PATTERN UPDATES BEFORE STARTING QUILT PROJECT.



Shades

Page 2



41290-X Multi



41291-1 Charcoal



41291-2 Bone



41292-1 Charcoal



41292-2 Bone



41292-3 Stone



41293-1 Charcoal



41293-2 Bone



41294-2 Bone



41295-1 Charcoal



41295-2 Bone



41296-1 Charcoal

SKU / COLOR	YDS
41290-X (Includes backing)	4
41291-1 (Includes border)	1 1/2
41291-2	1/2
41292-1	1/4
41292-2	1/2
41292-3	1
41293-1	3/4

SKU / COLOR	YDS
41293-2	3/4
41294-2	3/4
41295-1	1/2
41295-2	1/4
41296-1	1
37098-11 *	1
* From Palette	

INSTRUCTIONS

Block #1 – make 12

Fabric 41292-1 Charcoal

Cut 2 – 4½" w strip. Cut this strip into 12 – 4½" squares.(block centers)

Fabric 41291-2 Bone

Cut 3 – 4½" w strips. Cut these into 48- 2½" x 4½" rectangles.

Shades

Page 3

Fabrics 41292-3 Stone and 41296-1 Charcoal

Cut 6 – 2½" w strips from each fabric. Cut these into 96 – 2½" squares each. Draw a diagonal line on the backs of all of these squares.

Using the 24 of the 2½" x 4½" bone rectangles and the 24 -of the 2½" 41296-1 charcoal squares and 24 of the 41292-3 stone squares, make 24 of the following geese.

Lay a charcoal square on the right side of the rectangle. Stitch on the drawn line. Trim the corner off leaving a ¼" seam allowance. Press the seam toward the rectangle. Repeat on the left side using the 41296-1 charcoal squares. Trim and press the seam toward the corner.



Sew these geese to the sides of the 4½" block centers(41292-1charcoal). Press the seams toward the center square.



Using the remaining 24 - 2½" x 4½" bone rectangles, 24 of the remaining 2½" 41296-1 charcoal squares and 24 of the remaining 41292-3 stone squares, make 24 of the following geese(these are mirror image of the 24 previous geese).

Lay a stone square on the right side of the rectangle. Stitch on the drawn line. Trim the corner off leaving a ¼" seam allowance. Press the seam toward the rectangle. Repeat on the left side using the charcoal squares. Trim and press the seam toward the corner.



Fabric 41293-1 Charcoal

Cut 3 – 2½" w strips. Cut these into 48 – 2½" squares.

Sew these squares to the ends of the above geese. Press the seams toward the squares.



Sew these to the top and bottom of the center square. Press the seams toward the center.

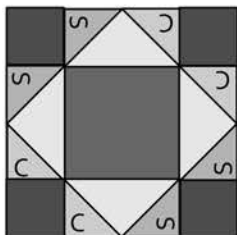

Fabric Colony Solid bone

Cut 3 – 4½" w strips. Cut these into 48- 2½" x 4½" rectangles.

Shades

Page 4

Using 24 of the 2½" x 4½" solid bone rectangles, the remaining 24 - 2½" 41296-1 charcoal squares and the 24 remaining 41292-3 Stone squares, make 24 of the following geese.

Lay a charcoal square on the right side of the rectangle. Stitch on the drawn line. Trim the corner off leaving a ¼" seam allowance. Press the seam toward the rectangle. Repeat on the left side using the stone squares.

Trim and press the seam toward the corner.



Fabric 41292-3 stone

Cut 4 - 2⅞" w strips. Cut these into 24 - 2⅞" squares.

Colony Solid bone fabric

Cut 4 - 2⅞" w strips. Cut these into 24 - 2⅞" squares. Draw a diagonal line on the back of all of the squares.

Lay the bone solid squares and the stone squares right sides together. Sew ¼" from both sides of the drawn line. Cut on the drawn line. Press the seam toward the dark side. You will have 48 pieced triangles.



Sew 24 of these pieced triangles to the right side of 24 of the above geese. Press the seams toward the geese.

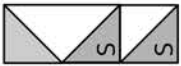

Fabric 41296-1 charcoal

Cut 4 - 2⅞" w strips. Cut these into 24 - 2⅞" squares. Draw a diagonal line on the back of all of the squares.

Palette Fabric

Cut 8 - 2⅞" w strips. Cut these into 48 - 2⅞" squares.

Lay the bone solid squares and the stone and charcoal squares right sides together. Sew ¼" from both sides of the drawn line. Cut on the drawn line. Press the seam toward the dark side. You will have 48 pieced triangles.



Sew 24 of these pieced triangles to the left side of the above geese. Press the seams toward the geese.



Sew these sections to the sides of the blocks. Press the seams toward the block.

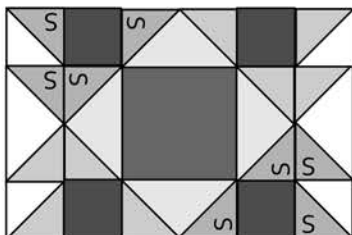

Shades

Page 5

Using the 24 remaining $2\frac{1}{2}'' \times 4\frac{1}{2}''$ solid bone rectangles and the 24 remaining $2\frac{1}{2}''$ 41296-1 charcoal squares and 24 remaining 41292-3 stone squares, make 24 of the following geese.

Lay a charcoal square on the right side of the rectangle. Stitch on the drawn line. Trim the corner off leaving a $\frac{1}{4}''$ seam allowance. Press the seam toward the rectangle. Repeat on the left side using the stone squares. Trim and press the seam toward the corner (these are mirror image of the 24 previous geese).



Sew the remaining charcoal pieced triangles to the right side of these geese. Press the seams toward the geese.

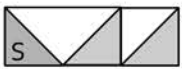

Sew the remaining stone pieced triangles to the left side of these geese. Press the seams toward the geese.



From the Colony Solid bone fabric cut 3 - $2\frac{1}{2}''$ w strips. Cut these into 48 - $2\frac{1}{2}''$ squares. Sew these to both ends of the above sections. Press the seams toward the squares.

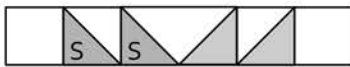

Sew these sections to the top and bottom of the blocks. Press the seams toward the center.

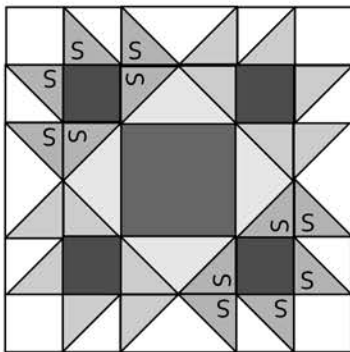

Block #2 - make 6

Fabric 41293-1 Charcoal

Cut 1 - $3\frac{1}{2}''$ w strip. Cut this strip into 12 - $3\frac{1}{2}''$ squares (block centers).

Cut 4 - $2''$ w strips. Cut these strips into 72 - $2''$ squares.

Fabric 41295-2 Bone

Cut 2 - $3\frac{1}{2}''$ w strip. From these strips cut 24 - $2'' \times 3\frac{1}{2}''$ rectangles.

Sew 12 of these to the sides of the center square. Press the seams toward the center square.



Shades

Page 6

Sew a 2" charcoal square to the ends of the remaining 2" x 3½" rectangles. Press the seams toward the squares. Sew these sections to the top and bottom of the center.

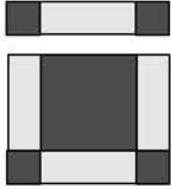

Fabric 41292-2 Bone

Cut 2 – 6½" w strips. From these strips cut 24 – 2" x 6½" rectangles.

Sew 12 of these to the sides of the center square. Press the seams toward the center square.



Sew a 2" charcoal square to the ends of the remaining 2" x 6½" rectangles. Press the seams toward the squares. Sew these sections to the top and bottom of the center.

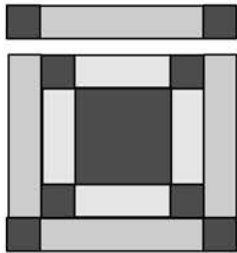

Fabric 41293-2

Cut 2 – 9½" w strips. From these strips cut 24 – 2" x 9½" rectangles.

Sew 12 of these to the sides of the center square. Press the seams toward the center square.

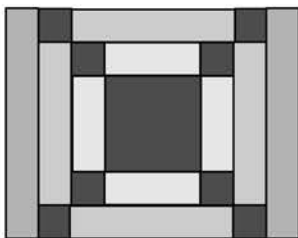

Sew a 2" charcoal square to the ends of the remaining 2" x 9½" rectangles. Press the seams toward the squares. Sew these sections to the top and bottom of the center.

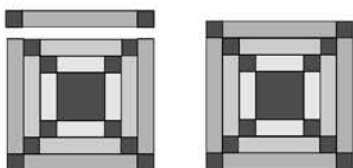

Shades

Page 7

Setting Triangles

Fabric 41294-2 Bone

Cut 2 – $6\frac{5}{8}$ "w strips. Cut one end on a 45° angle. Measure $13\frac{1}{4}$ ". Cut another 45° angle. Measure $13\frac{1}{4}$ ". Cut another 45° angle. You will get 5 setting triangles from each strip. Cut a total of 10 setting triangles.

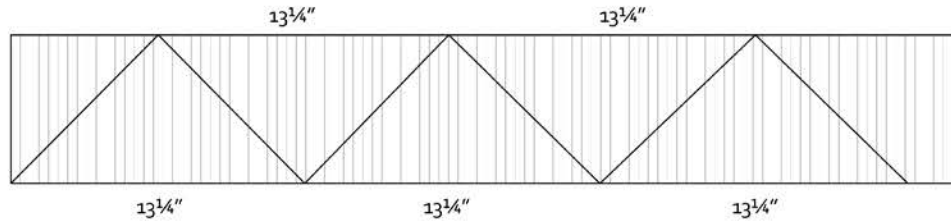

Using the quilt photo as a guide, sew the setting triangles and blocks into diagonal rows starting in one corner. Alternate block #1 and #2 in rows 2 – 5. Press the seams toward the setting triangles and Block #2 in each row.

Corner Triangles

Fabric 41294-2 Bone

Cut 1 – $5\frac{3}{8}$ "w strip. Cut one end on a 45° angle. Measure $7\frac{1}{4}$ ". Cut another 45° angle. Measure $7\frac{1}{4}$ ". Cut another 45° angle. Cut 4 triangles.

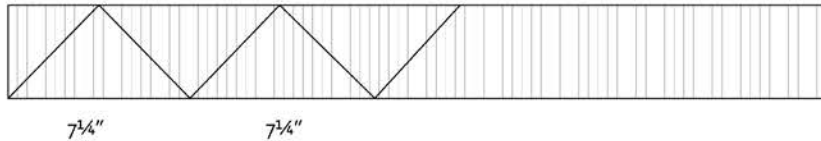

Sew these to the corners of the quilt. Press the seams toward the triangles.

Border

Fabric 41291-1 Charcoal

Cut 7 – $6\frac{1}{2}$ "w strips. Sew them into one long strip. I like to cut the ends on a 45° angle before sewing them together.

Measure the length of the quilt top. From the long strip, cut two border strips this length. Sew them to the sides of the quilt top. Press the seams toward the border strips.

Measure the width of the quilt top. Cut two border strips this length. Sew them to the top and bottom of the quilt top. Press as before.

Finishing

Fabric 41290-X Multi

Cut the fabric in half. Sew the halves together with a 1" seam allowance. Remove the selvages. Press the seam open.

Layer the backing, batting and quilt top.

Baste and quilt as desired.

Fabric 41295-1 Charcoal

Cut 8 – $2\frac{1}{4}$ "w strips. Sew them into one long strip. Bind your quilt.

Enjoy!